

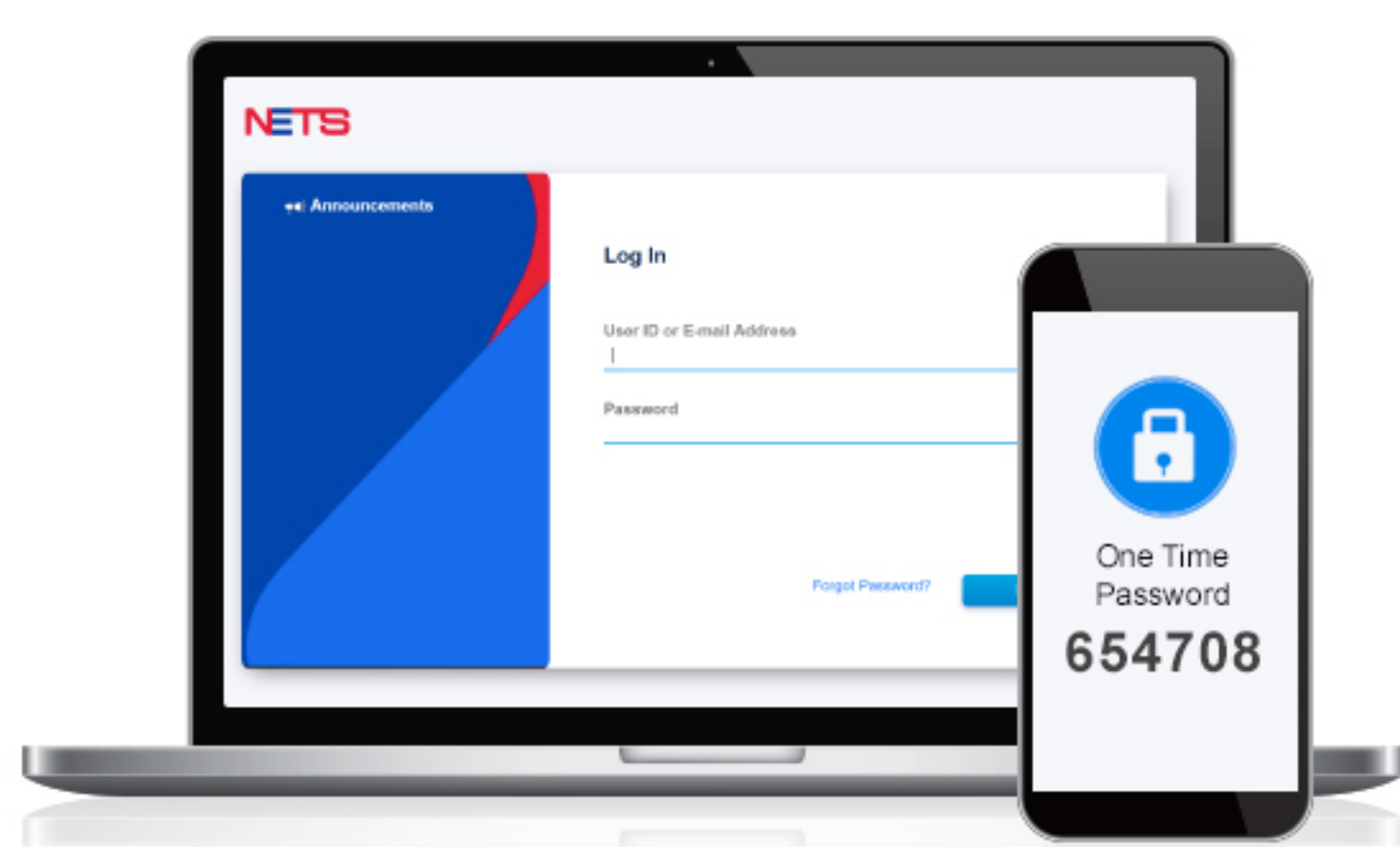

MerchantConnect UNVEILING FRESH CHANGES

Introducing the refreshed MerchantConnect

Here, you can continue to manage your transactions and data more effectively. The redesigned portal aims to be an easy-to-use tool with enhanced security and advanced search functionality.



Login with your email

From today, MerchantConnect login will be replaced with an email address login. Please follow the one-time process below to enter your email address.

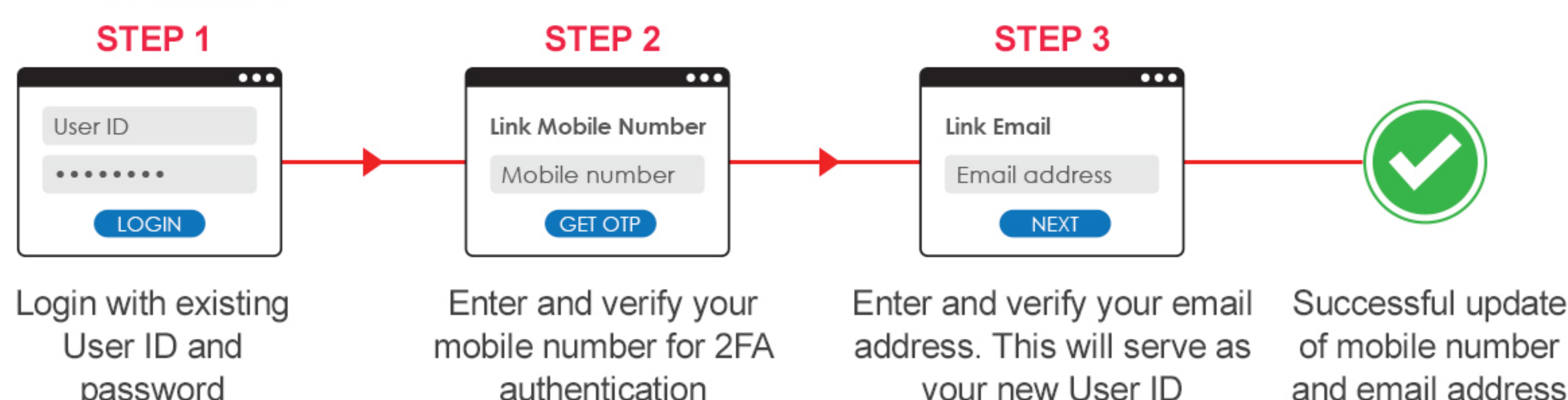

Following these steps, you will receive an email to update your password. Your registration will be complete upon successful password change.

Please note that you will not be able to login with your existing User ID from 15th December 2020.

Data search made easy

MerchantConnect consolidates data from all payment modes, transaction types and sales channels. It enables you to track buyers across multiple channels and spending patterns. Create customised reports and generate them within seconds.

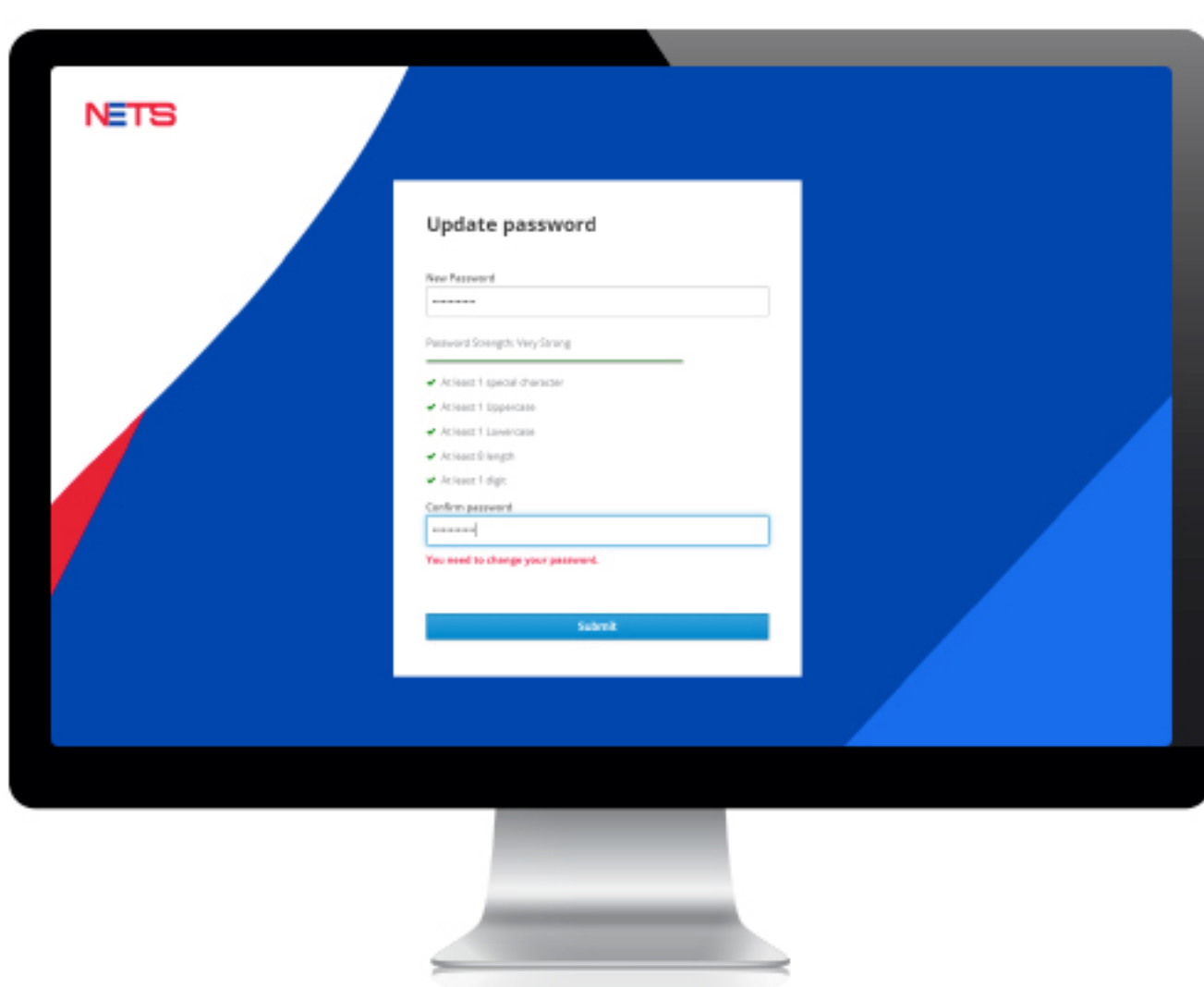
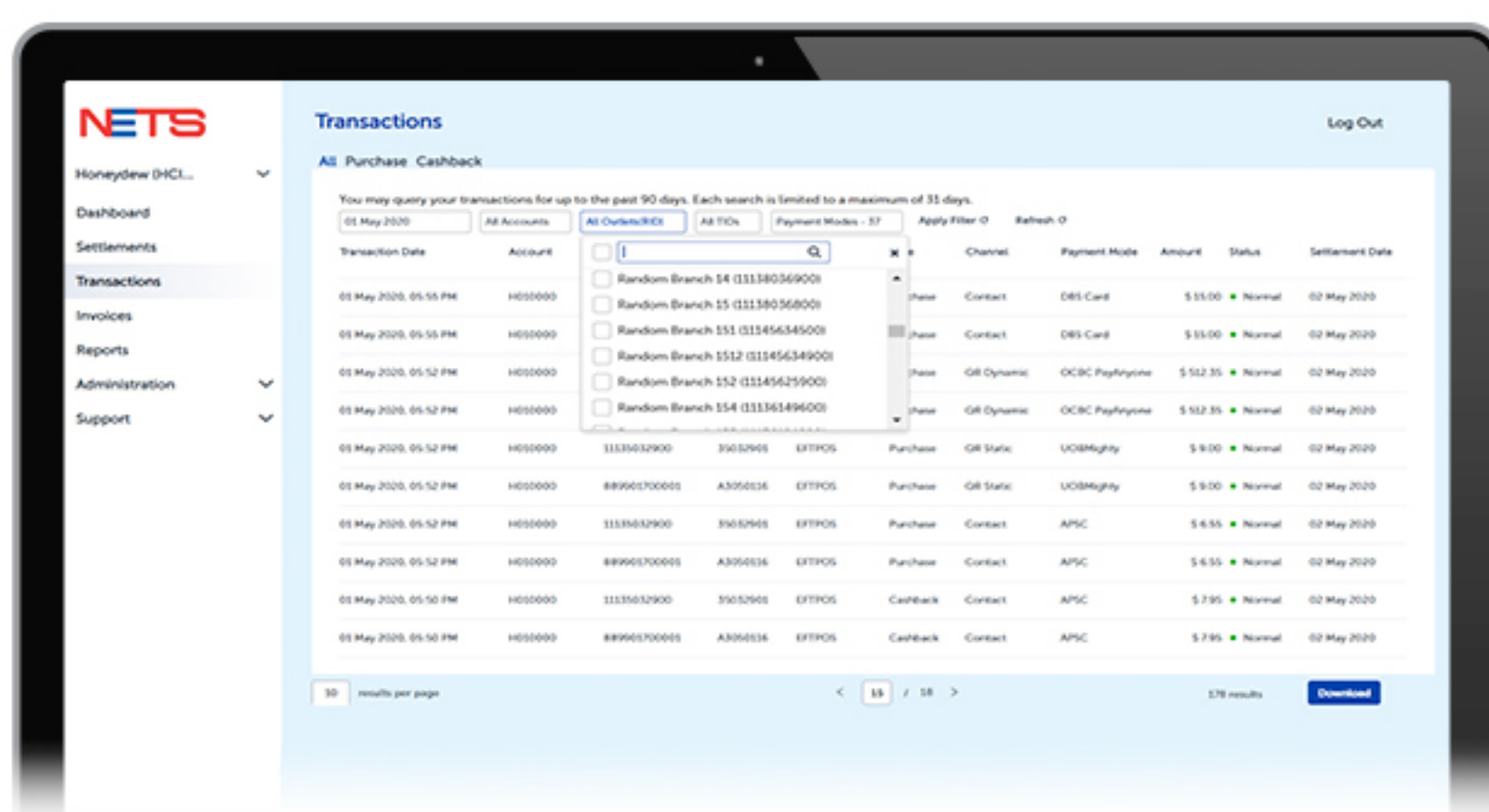

Managing your password

Can't log in because your account is locked? Or forgot your password? You can reset the password yourself to continue to use the MerchantConnect.

[Check out MerchantConnect now!](#)

Download [User Guide](#) or [FAQs](#).

[Request for Online Training](#)

For more information, please contact NETS Customer Service Hotline



6274 1212



info@nets.com.sg